

Side looking rail retractable canal mount for Acoustic Doppler Current Meter (ADP / ADCP) instruments SLM-B

Parts guide and assembly notes

Revised September 4th 2009

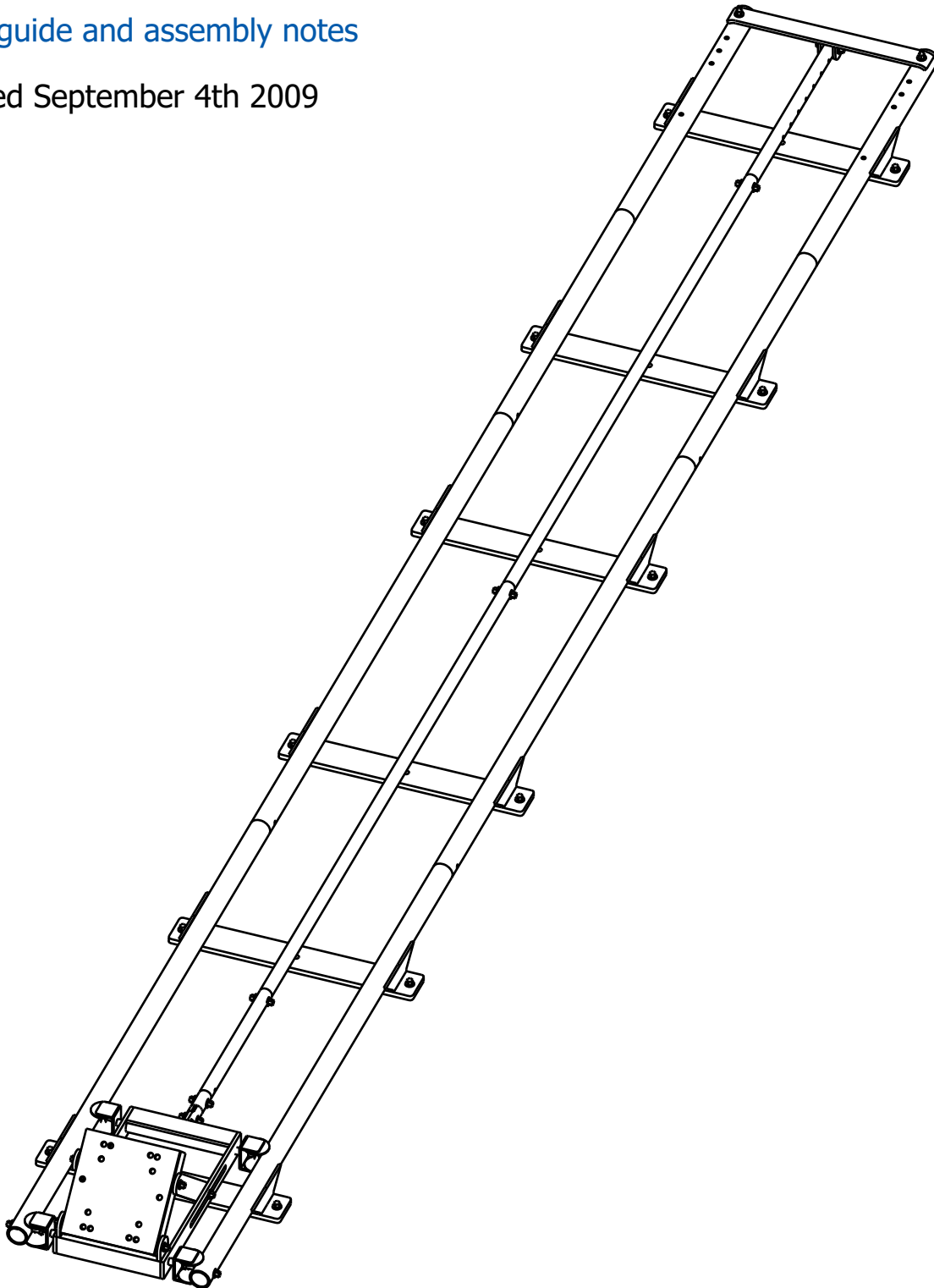

Side looking rail retractable canal mount for Acoustic Doppler Current Meter (ADP / ADCP) instruments SLM-B

Parts guide and assembly notes

Bottom 4' rail segment

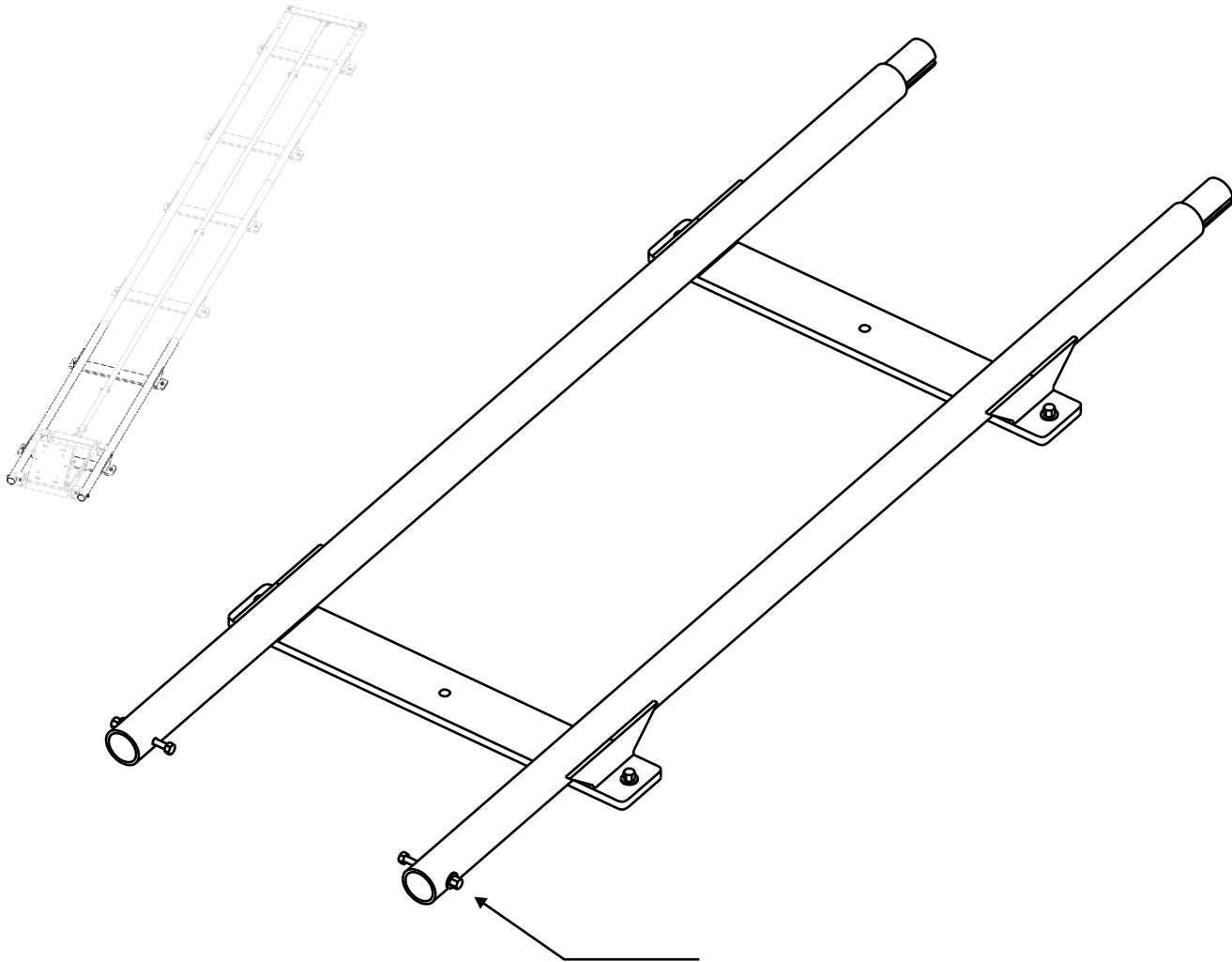

Identify part by noticing the
carriage stop bolts

Side looking rail retractable canal mount for Acoustic Doppler Current Meter (ADP / ADCP) instruments SLM-B

Parts guide and assembly notes

Standard 4' rail extension segment(s)

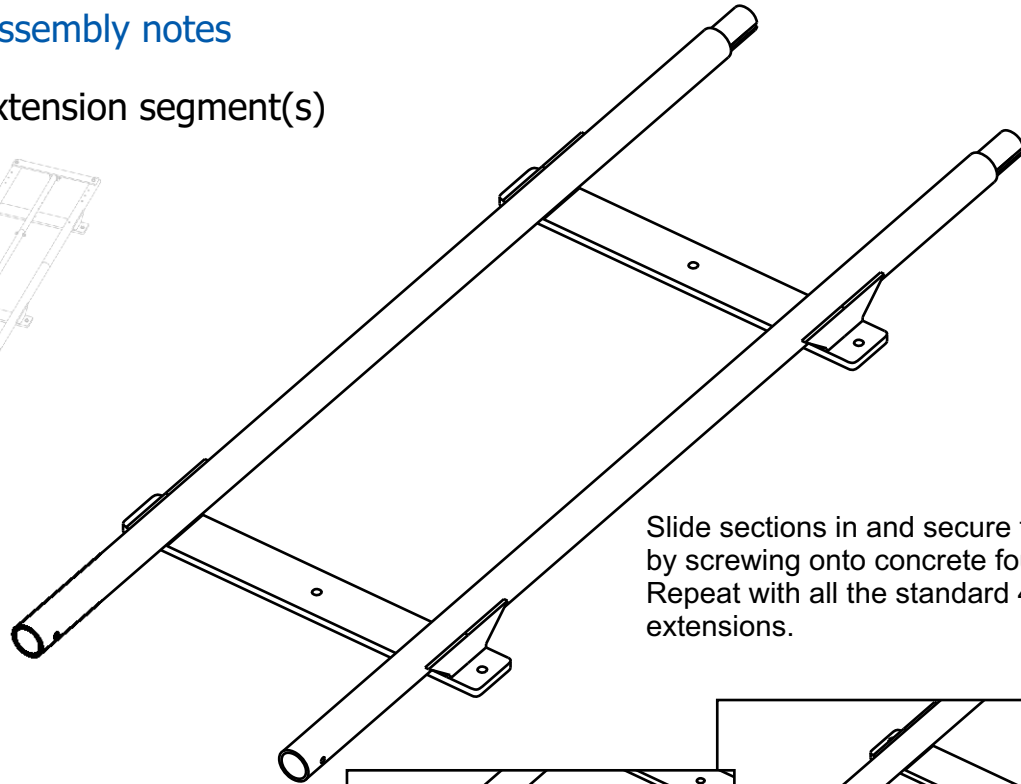
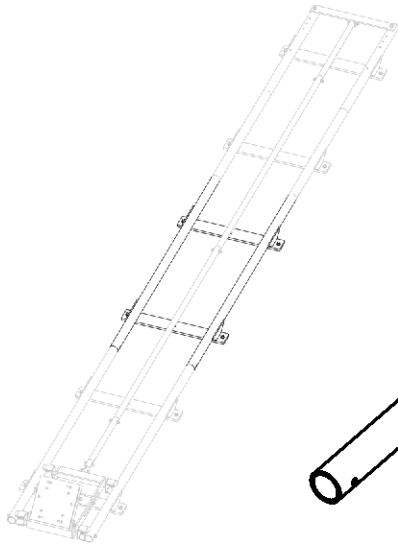

Slide sections in and secure the mount by screwing onto concrete foundation. Repeat with all the standard 4' rail extensions.

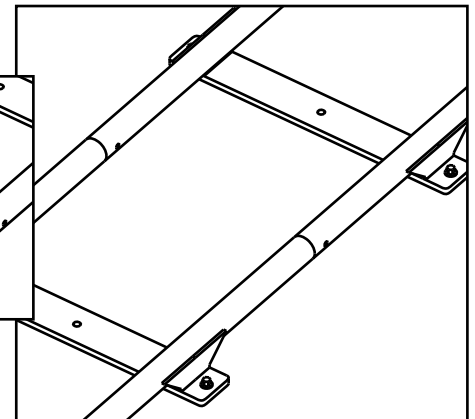
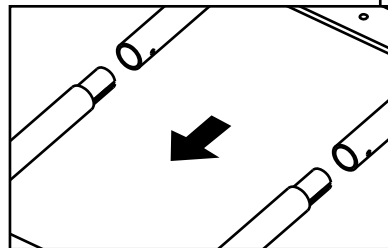

Optionally, help keep sections together before mounting onto concrete foundation by inserting screws to expand the inner insert

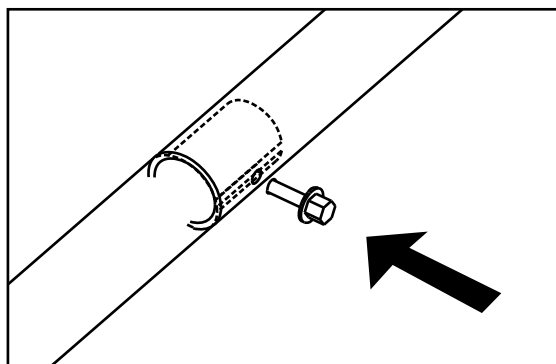

Side looking rail retractable canal mount for Acoustic Doppler Current Meter (ADP / ADCP) instruments SLM-B

Parts guide and assembly notes

Top 4' rail segment

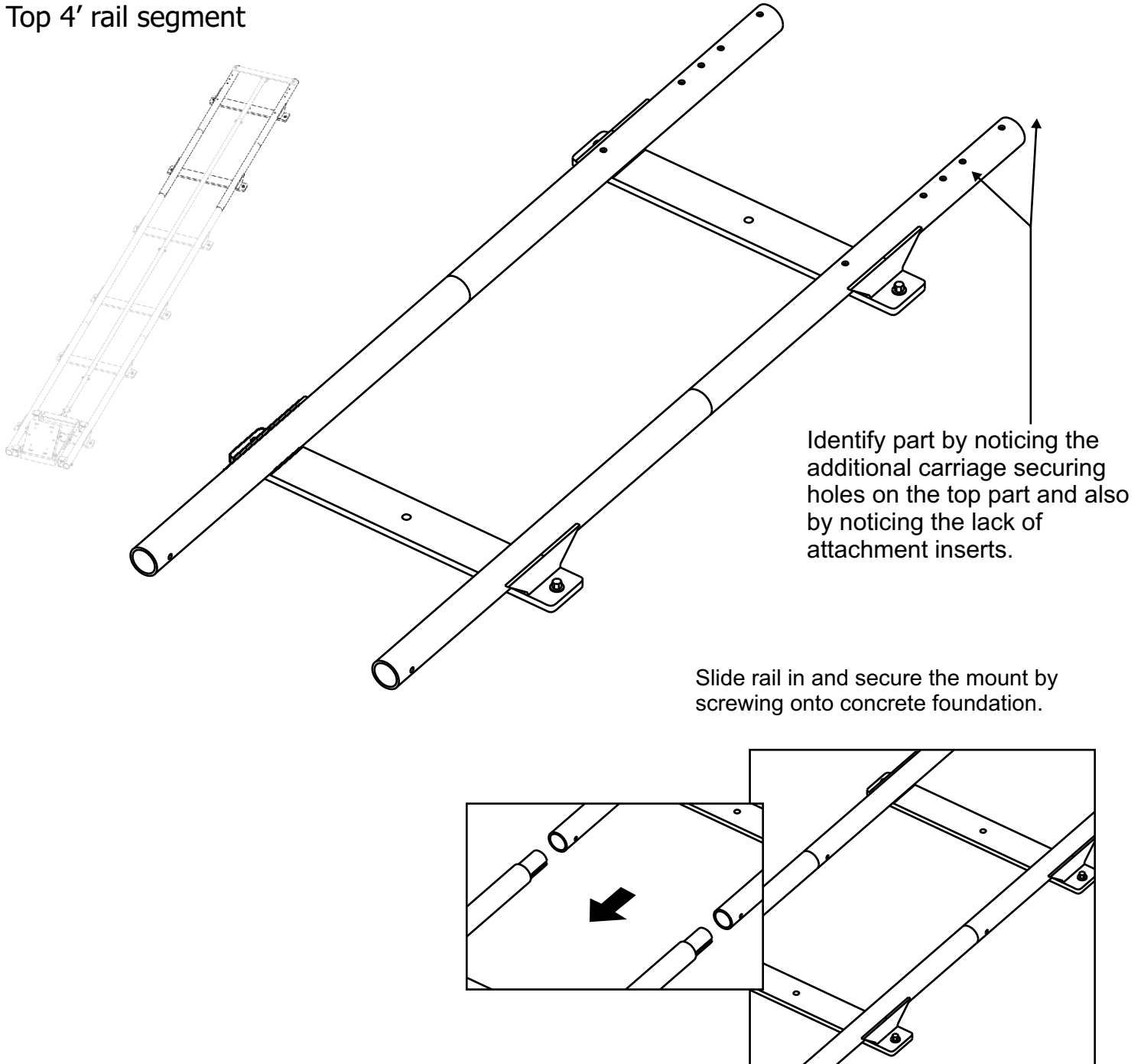

Side looking rail retractable canal mount for Acoustic Doppler Current Meter (ADP / ADCP) instruments SLM-B

Parts guide and assembly notes

Instrument platform and carriage

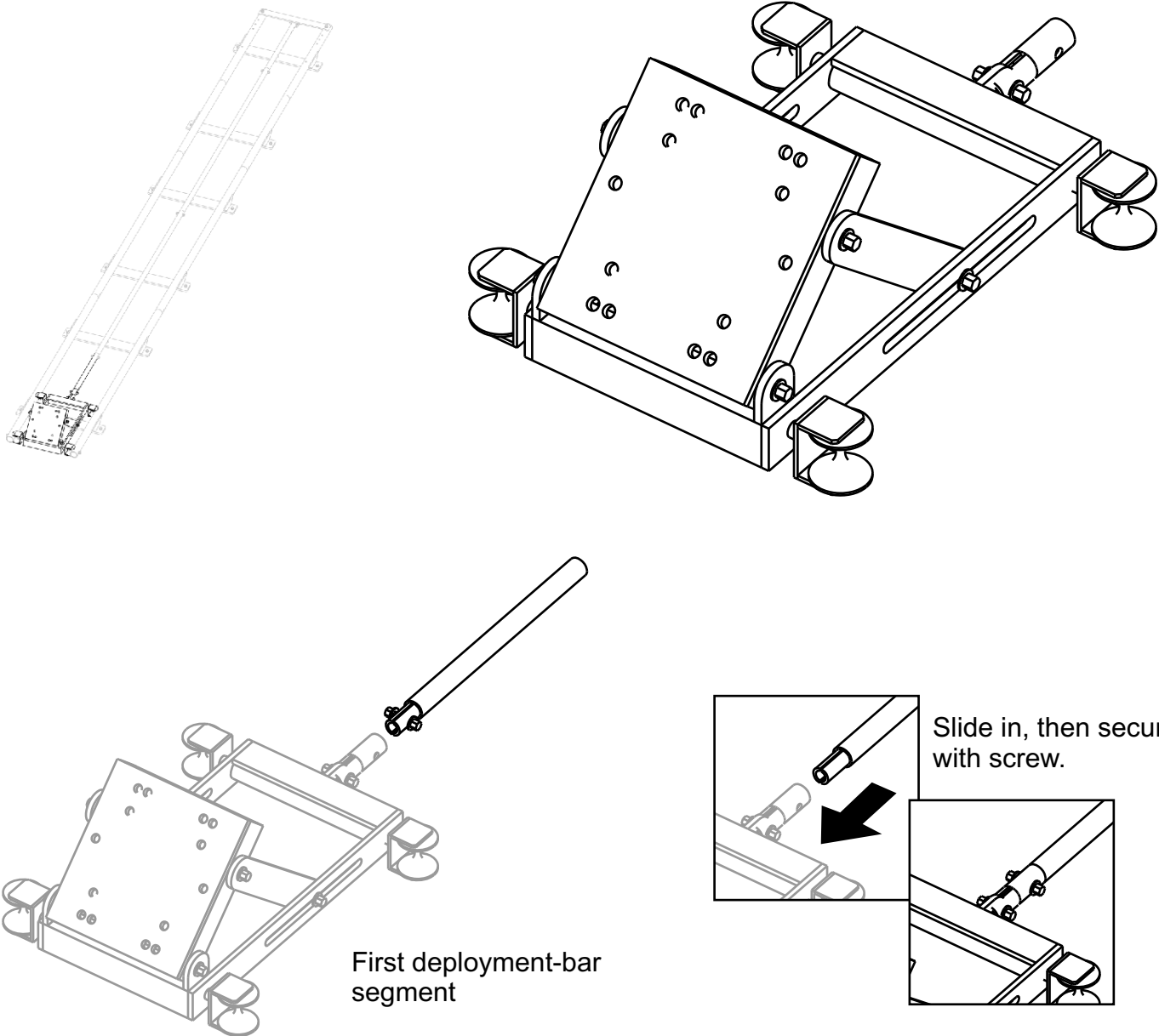

Side looking rail retractable canal mount for Acoustic Doppler Current Meter (ADP / ADCP) instruments SLM-B

Parts guide and assembly notes

4' deployment-bar extension segment

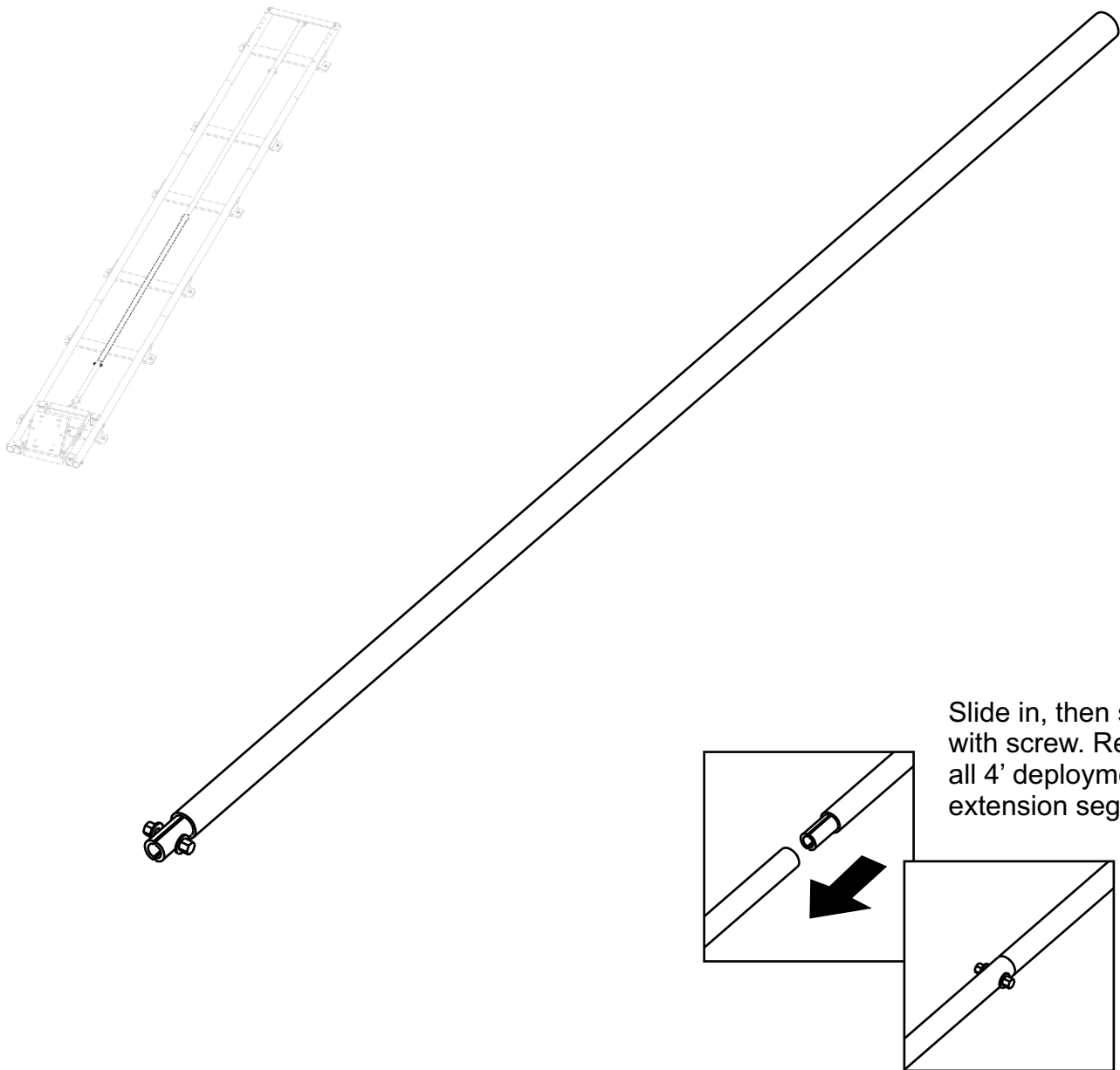

Side looking rail retractable canal mount for Acoustic Doppler Current Meter (ADP / ADCP) instruments SLM-B

Parts guide and assembly notes

deployment-bar top segment

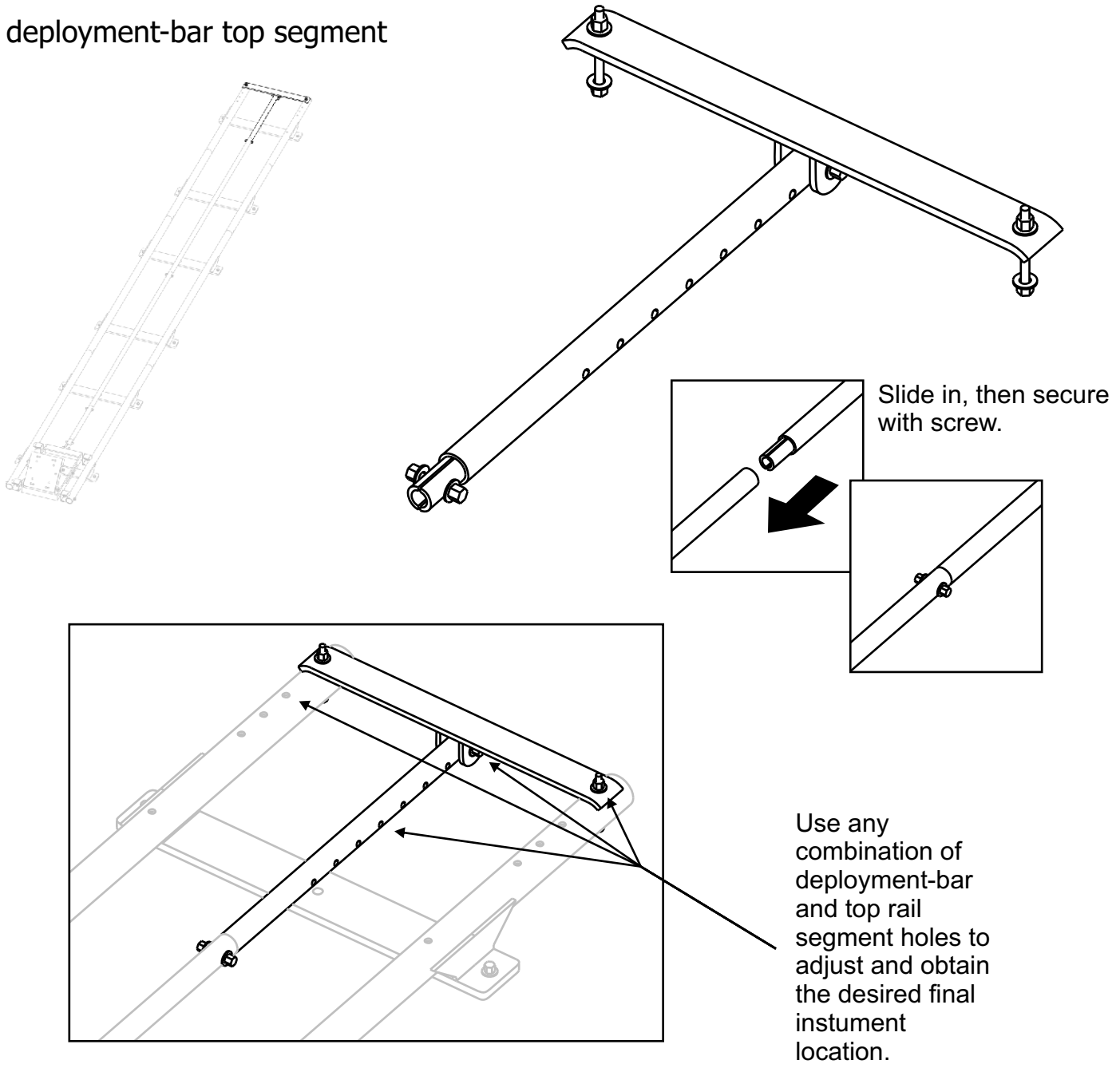

Side looking rail retractable canal mount for Acoustic Doppler Current Meter (ADP / ADCP) instruments SLM-B

Parts guide and assembly notes

Attach the instrument onto the mounting plate using the screws provided by the ADP instrument manufacturer.

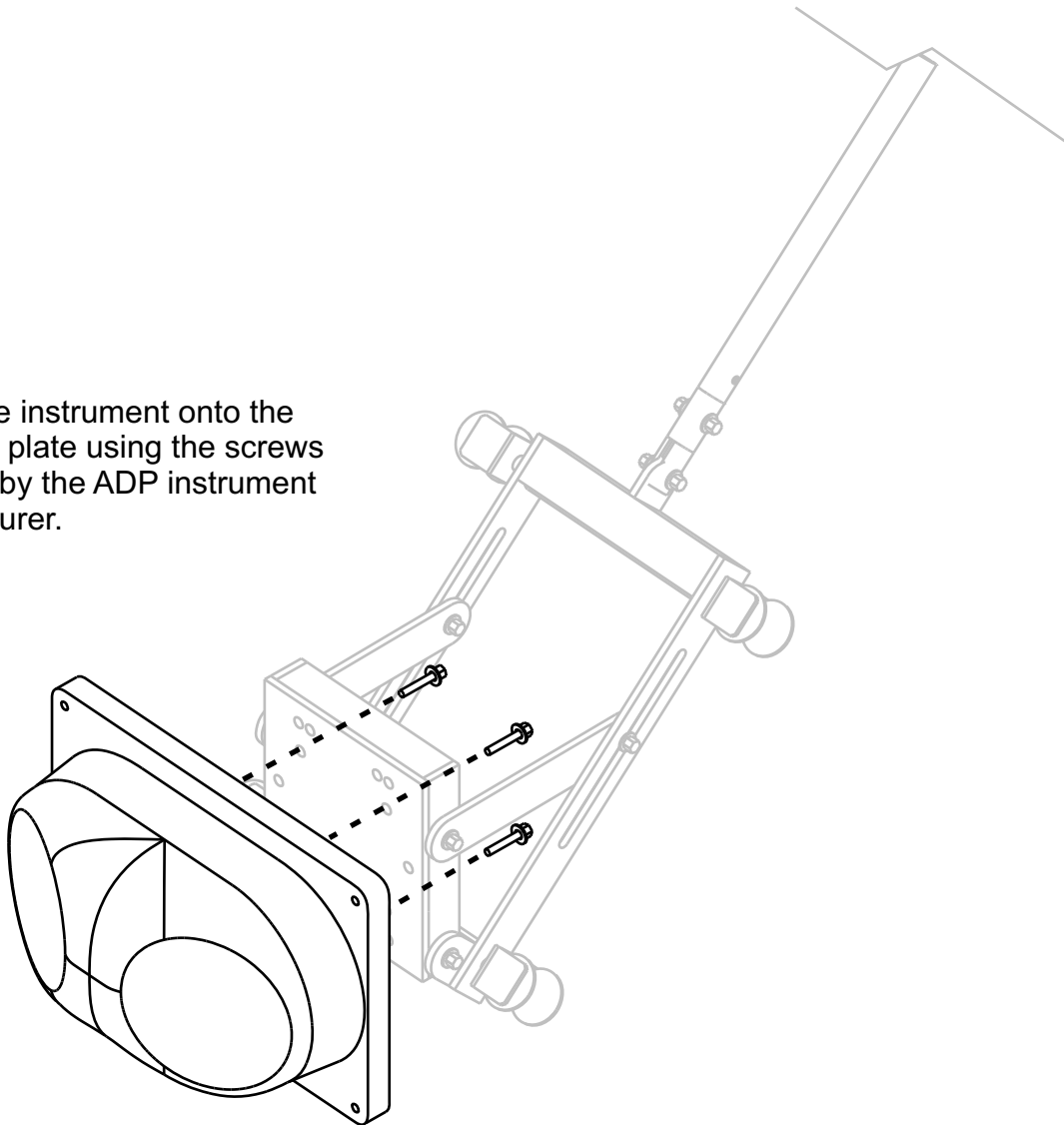

Side looking rail retractable canal mount for Acoustic Doppler Current Meter (ADP / ADCP) instruments SLM-B

Parts guide and assembly notes

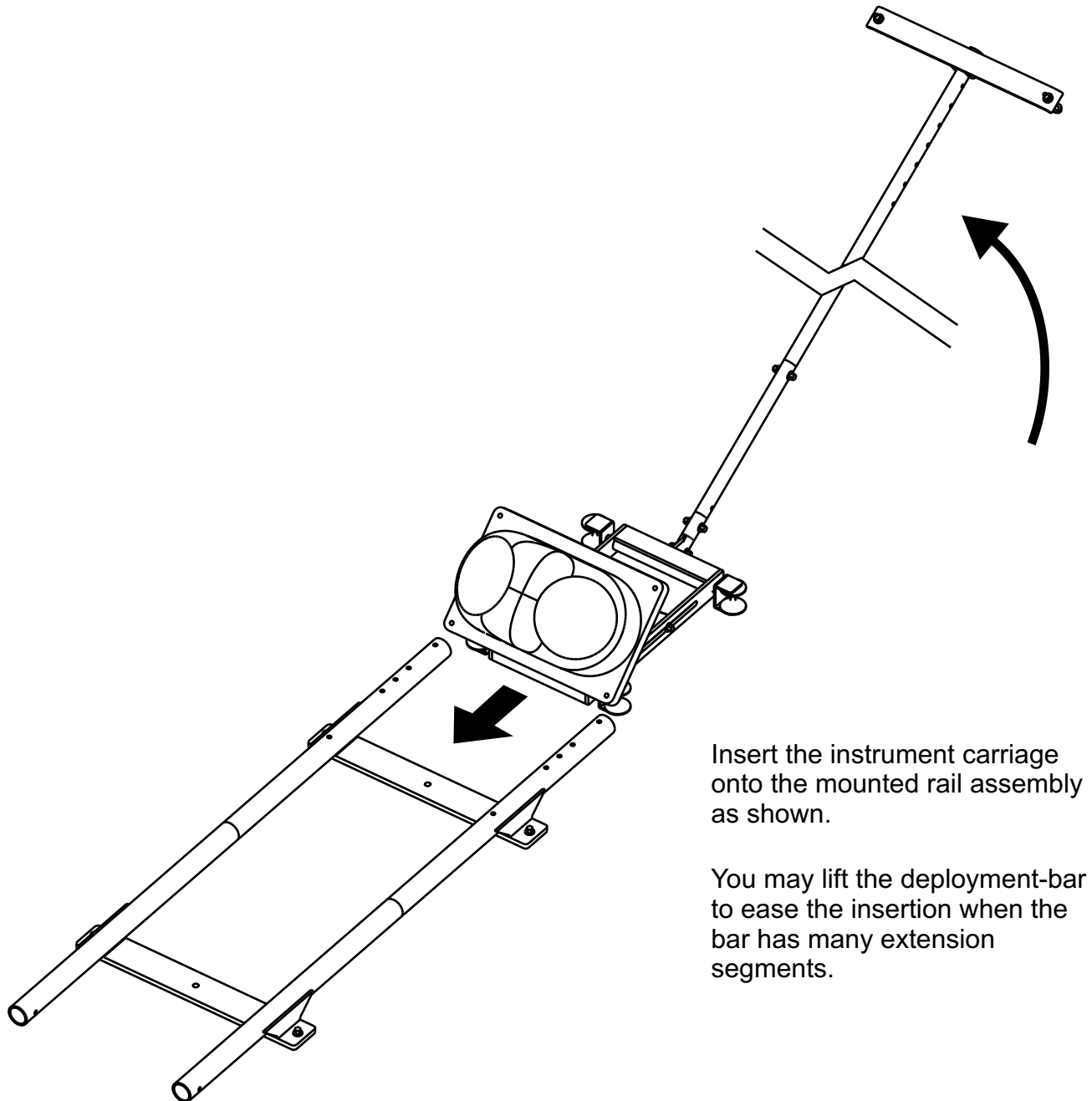

Insert the instrument carriage onto the mounted rail assembly as shown.

You may lift the deployment-bar to ease the insertion when the bar has many extension segments.

Side looking rail retractable canal mount for Acoustic Doppler Current Meter (ADP / ADCP) instruments SLM-B

Parts guide and assembly notes

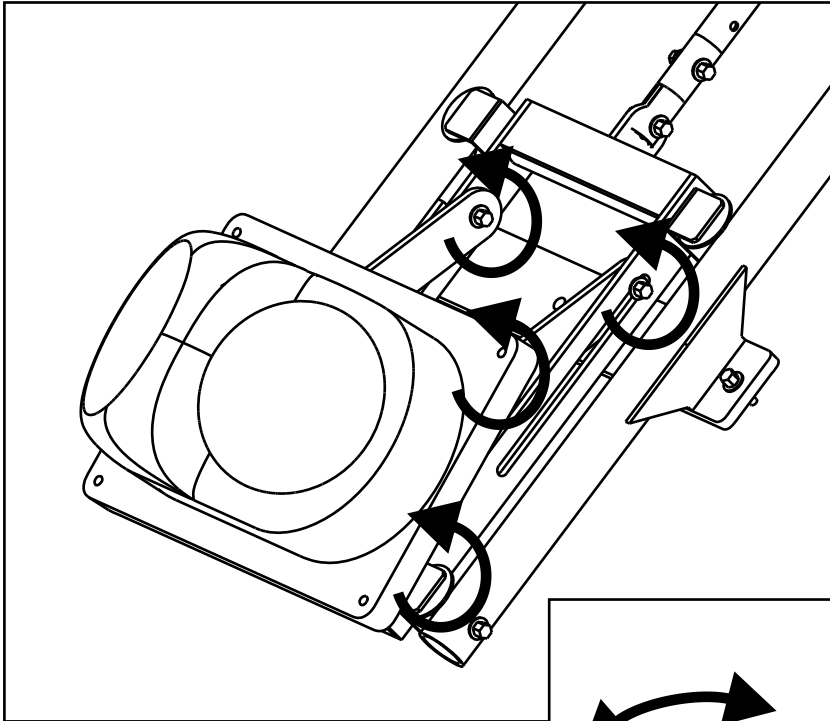

Loosen the screws that allow the platform to slide and tilt.

Mount and align the ADP instrument.

The use of a level is recommended to achieve a perfect parallel-to-the-ground alignment.

Tighten all the screws.

